

Primary Care Centre Hall'ith Wood, Bolton for Bolton Primary Care Trust



Practice Provision:
13 GP Primary Care Resource Centre, reproviding 2 local practices, together with PCT Services, Pharmacy, Expansion Space and Community Centre.

Floor Area (GIA):
GMS space 2815 sqm
Pharmacy 185 sqm
Expansion 1100 sqm
Community Centre 450 sqm
Car Park 120 spaces

Development Value:
£9 million

Completion Date
November 2007

LSP were appointed as Assura's development partner for the provision of the new 13 GP Primary Care Centre, in Bolton, to provide for 2 existing practices, PCT services and an integral pharmacy.

A tight site was secured from Bellway Homes, which was the subject of a S.106 agreement for the provision of a doctors surgery. Further land was secured from the adjacent church, on which we have provided a new community centre. A final section of land was acquired from a private vendor in order to provide sufficient car parking for both the Medical Centre and Community Centre along with a 'park and ride' facility for Bolton Metropolitan Council and the adjacent railway station.

The overall size of the medical centre and community centre is circa 4500 sqm, incorporating an integrated pharmacy and 15% expansion space. The size of the scheme was such that economies of scale enabled the principle of 'value for money' to be maintained.

Site Layout

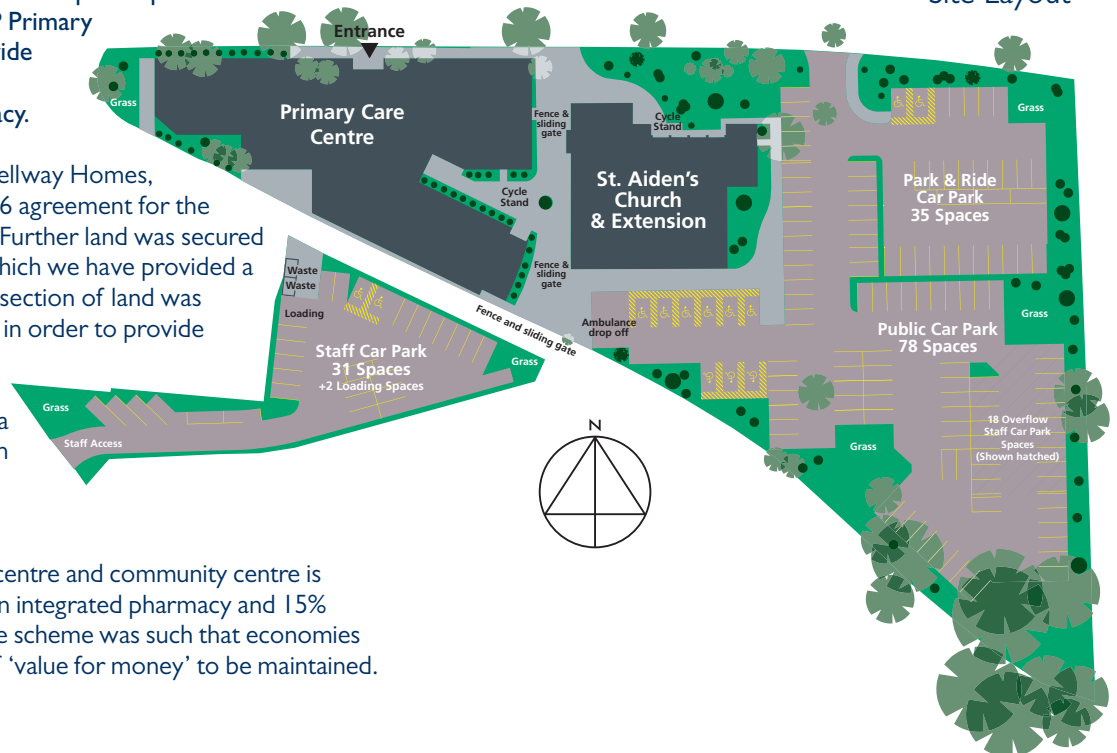

Primary Care Centre Hall'ith Wood, Bolton for Bolton Primary Care Trust



Development Team:
Project Co-ordinator:
Phil Lilley: LSP Developments Limited

Funder/Long Term Landlord:
Assura Property Limited

Architectural Design:
West Hart Partnership

Construction:
Multibuild Limited

