

# The Grange Family Health Centre Chesterfield for Holywell Medical Group



#### Practice Provision:

4 GP practice, plus PCT services, integrated pharmacy and expansion space

#### Floor Area:

GMS Space: 1,185 sqm  
PCT Space: 140 sqm  
Pharmacy: 120 sqm  
Expansion: 152 sqm  
Car Park 45: spaces

#### Development Value:

£3.2 million

#### Completion Date:

May 2010

LSP in conjunction with Assura were appointed by the Holywell Medical Group to provide a new surgery in the district of Grangewood in Chesterfield, where there was an under provision of GMS services with a high number of unregistered patients.

The practice had already secured a site on Stubbings Road, Chesterfield, at the heart of the prospective patient catchment. The site was quite tight and therefore, LSP's team were challenged to come up with a highly legible three storey scheme, to ensure plenty of on-site car parking was provided. The ground floor comprises high volume GMS space, together with the integrated pharmacy; the first floor dental suite and minor operations/treatment suite; the second floor administration space.

The development started on site in June 2009 and was completed by May 2010. Assura not only funded the development but act as long term landlord. The development was officially opened on 16th March 2011 by the Duke of Devonshire, along with the Mayor and Mayoress of Chesterfield.

Site Layout:

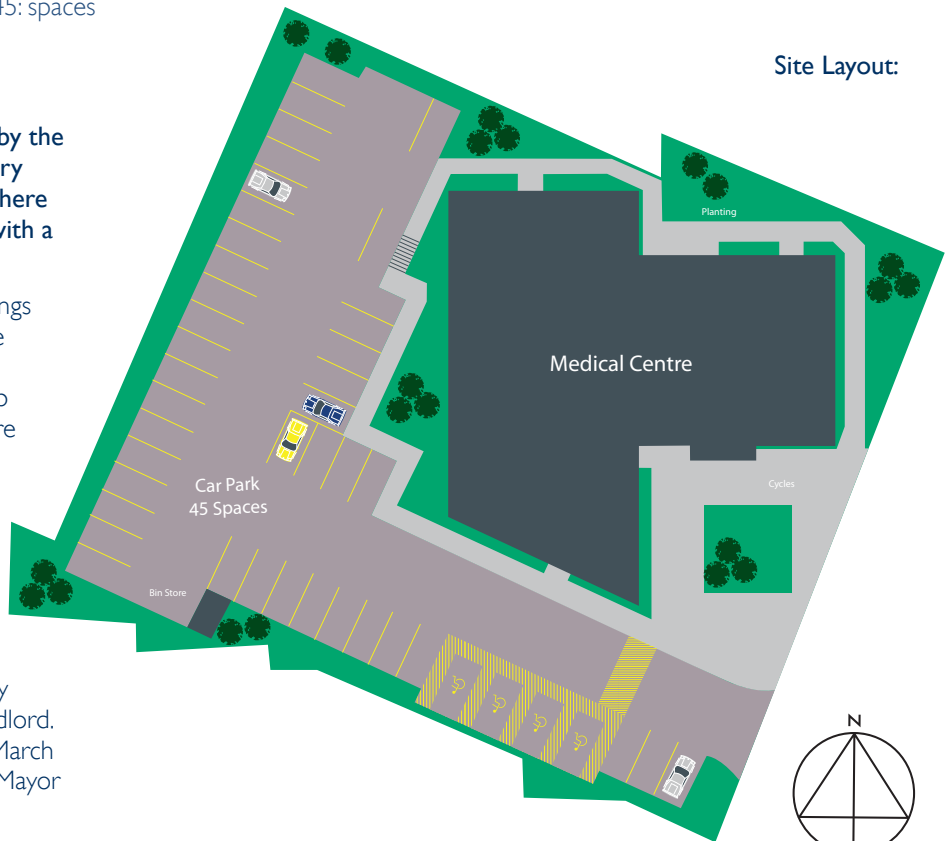

# The Grange Family Health Centre Chesterfield for Holywell Medical Group

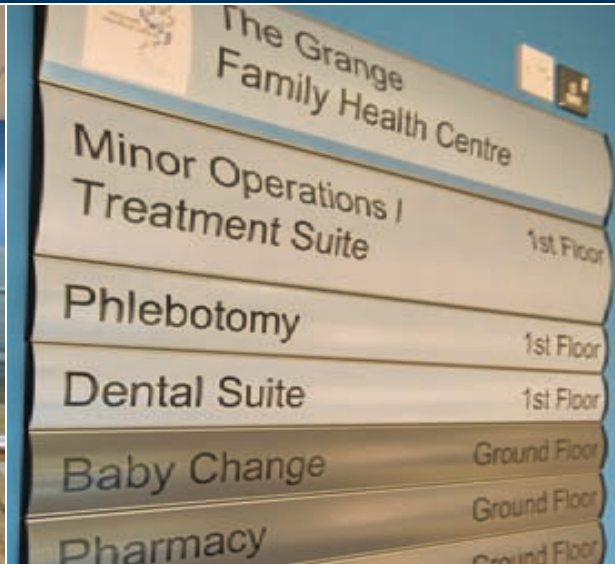

Ground Floor Plan:

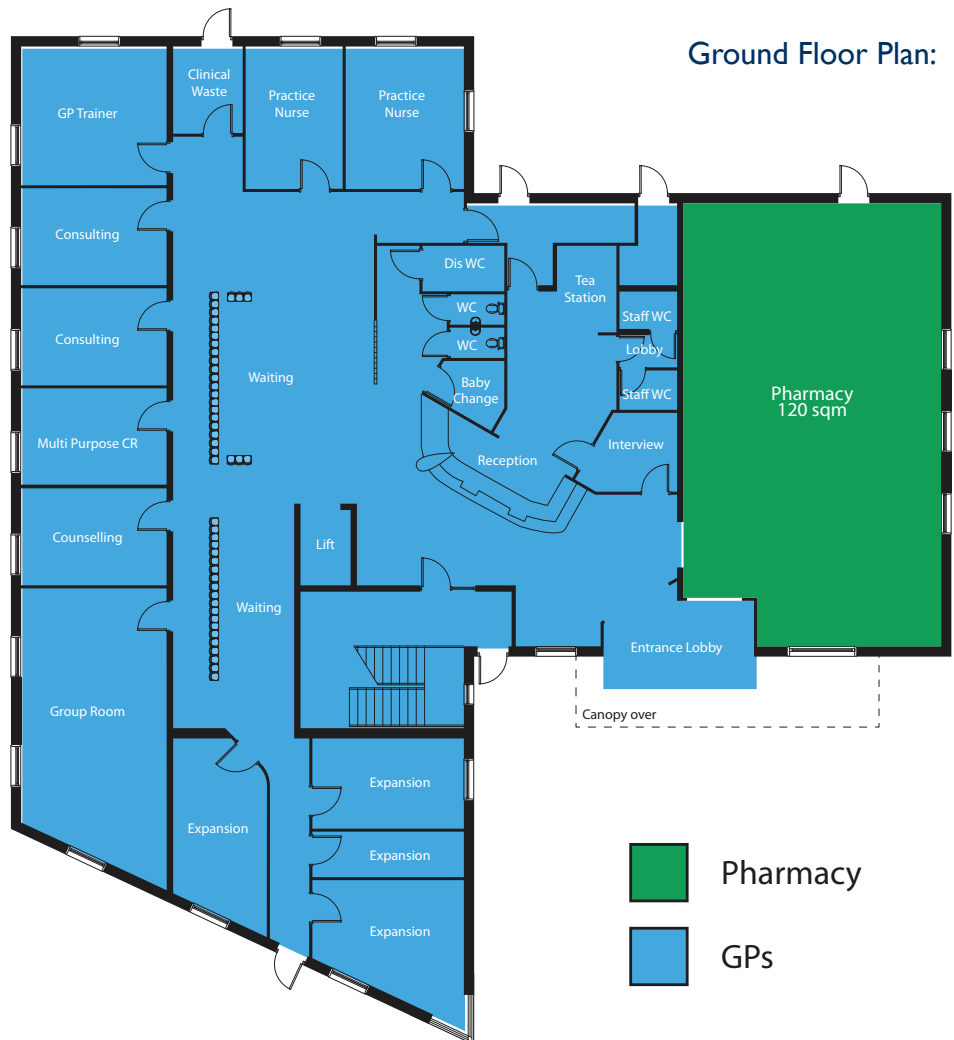

**Development Team:**  
**Project Co-ordinator:**  
Ed Sutton: LSP Developments Limited

**Funder/Long Term Landlord:**  
Assura Property Ltd

**Architectural Design:**  
West Hart Partnership Ltd

**Construction:**  
Jaybuild Projects Limited